

42" LYNX PROFESSIONAL GRILL



Built-In



Freestanding

The innovative features, unparalleled performance, and superior craftsmanship of Lynx Professional Grills are available in 27", 30", 36", 42", and 54" configurations for built-in or freestanding application.

FEATURES:

- All Trident, Trident and all briquette models available (up to 91,000 BTUs)
 - 1200 sq. in. cooking surface (855 primary, 345 secondary)
 - Hot surface ignition system
 - Heat stabilizing design
 - Control illumination w/ blue LEDs
 - Dual halogen grill surface lights
 - Temperature gauge
 - Fluid rotation handle
 - Lynx Hood Assist Kit
 - Removable large-capacity smoker box
 - Stainless steel grilling grates
 - Dual-position internally powered rotisserie w/ heavy-duty 3-speed motor & rear infrared burner

42" LYNX PROFESSIONAL GRILL COMES IN 5 MODELS:

MODEL	DESCRIPTION
L42R-3	42" Built-In Grill w/ Rotisserie
L42TR	42" Built-In Grill - 1 Trident IR Burner w/ Rotisserie
L42ATR	42" Built-In Grill - All Trident IR Burner w/ Rotisserie
L42TRF	42" Freestanding Grill - 1 Trident IR Burner w/ Rotisserie
L42ATRF	42" Freestanding Grill - All Trident IR Burner w/ Rotisserie

SHIPPING WEIGHTS & DIMENSIONS:

Built-In: 346 lbs

Dimensions: 51.5" x 34" x 34"

Cut-Out Dimensions: 41" x 10.88" x 24.5"

Freestanding Grill: 524 lbs

Dimensions: 51.5" x 54.5" x 34"

For more information, please call **1.888.289.5969** or visit **www.lynxgrills.com**

LYNX BUILT-IN 42"
W/ DIMENSIONS
ISLAND CUTOUT IN BLUE

TOP VIEW

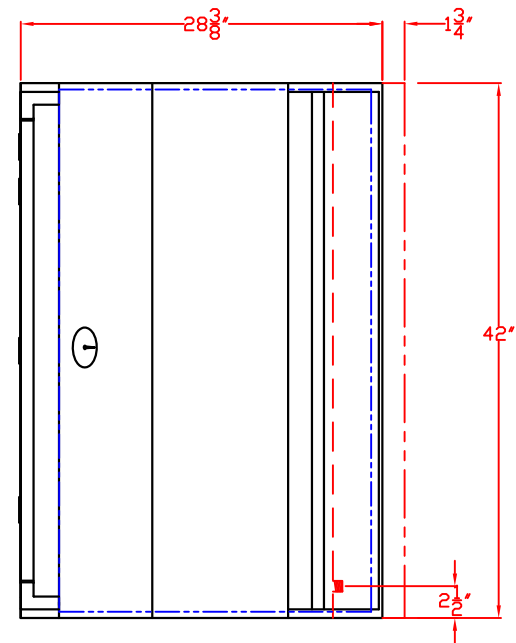

FRONT VIEW

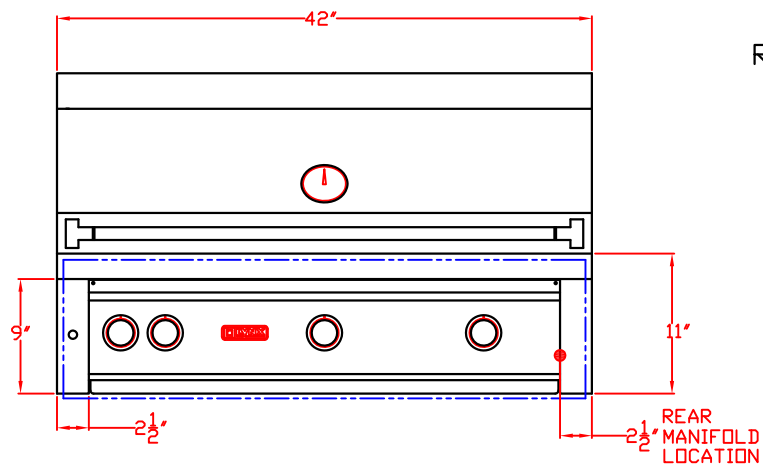

RIGHT SIDE VIEW

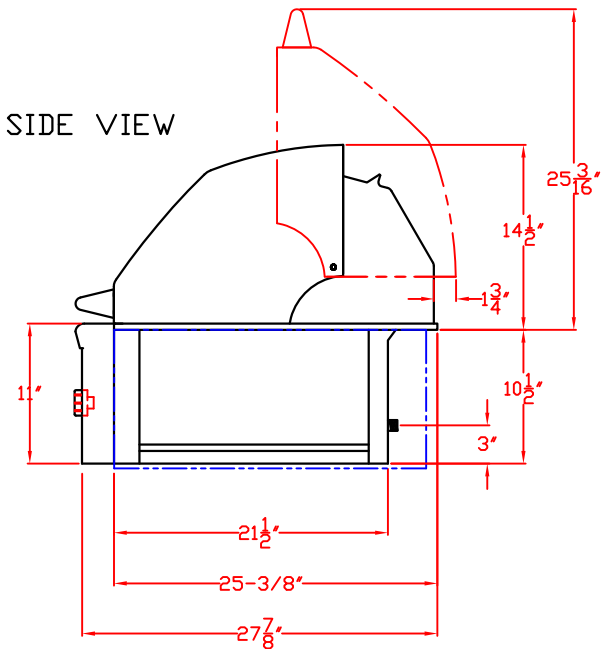

LYNX BUILT-IN 42" ISLAND CUTOUT

TOP VIEW

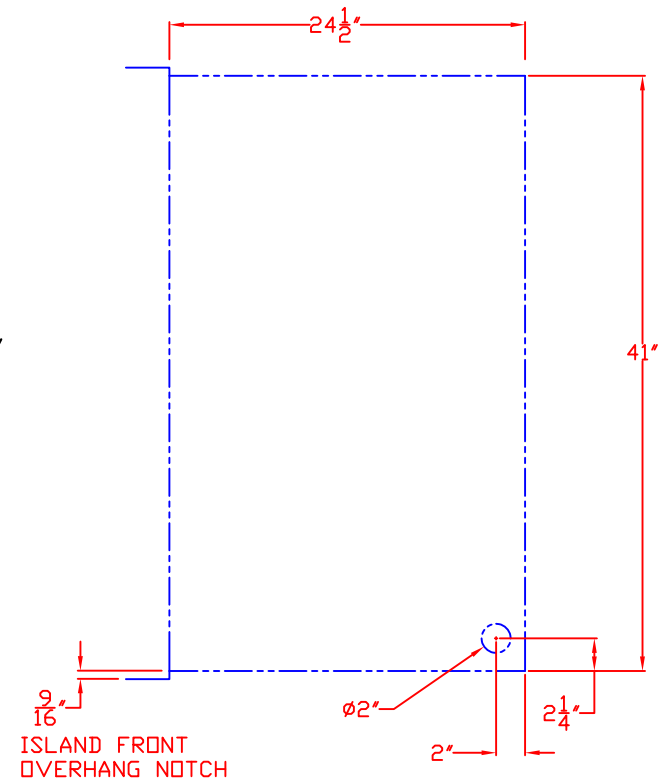

FRONT VIEW

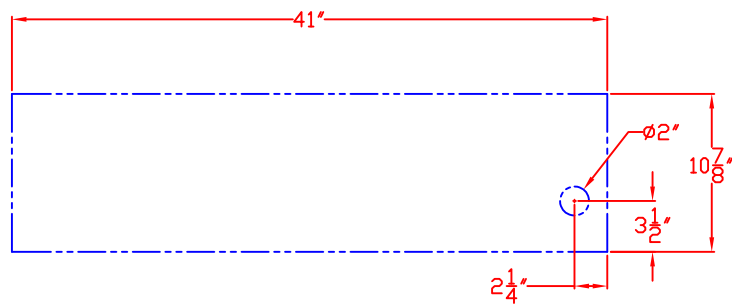

SIDE VIEW

